

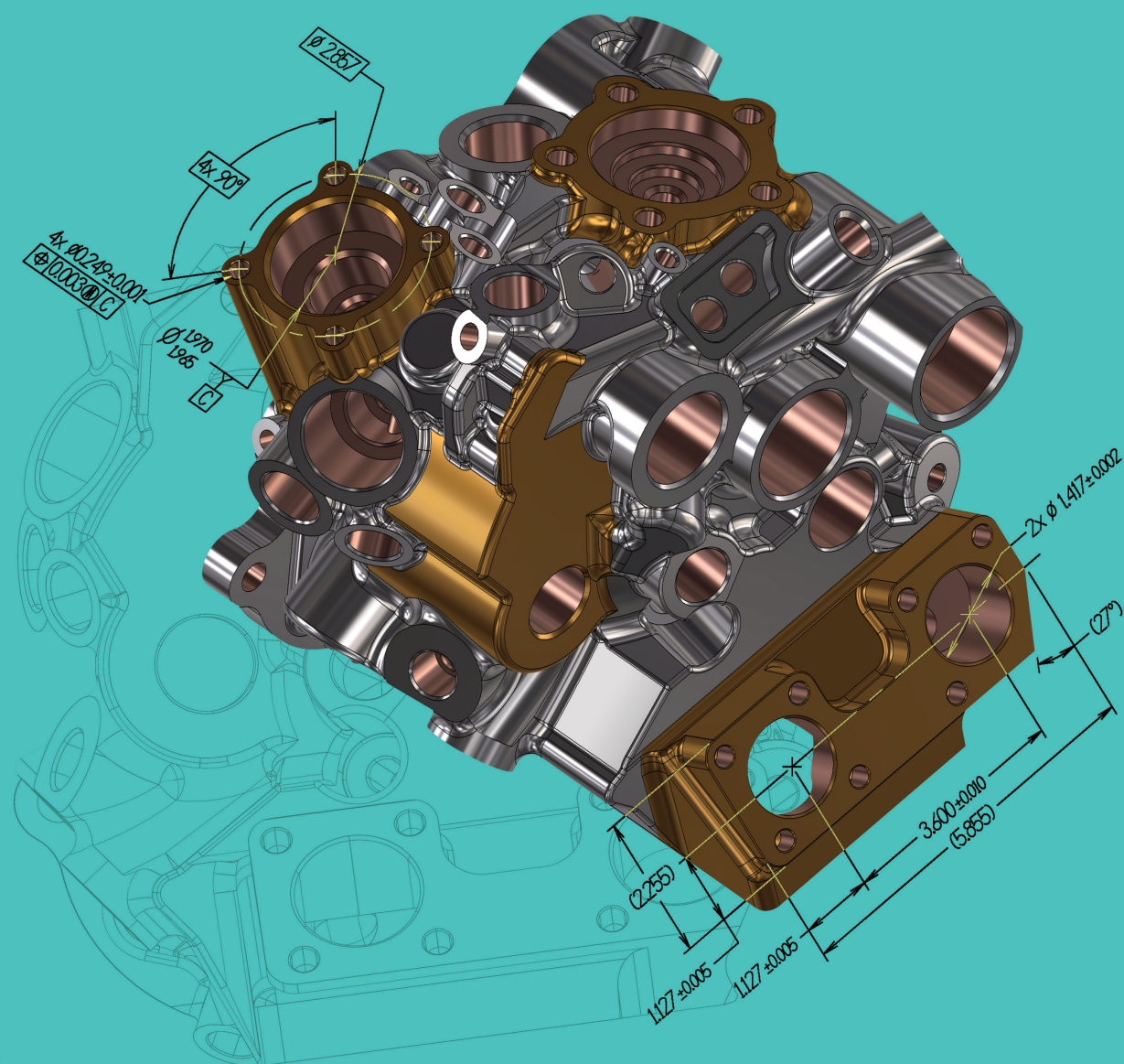

DESIGN



Streamlined CAD makes design work easier than ever.

MODELING AND PREP TOOLS TO GET YOUR PARTS ON AND OFF THE MACHINE QUICKLY

Whether you're bringing in a file from an outside CAD package or designing one yourself, Mastercam's powerful, easy-to-use CAD engine gives you control over the final details of even the most complex jobs.

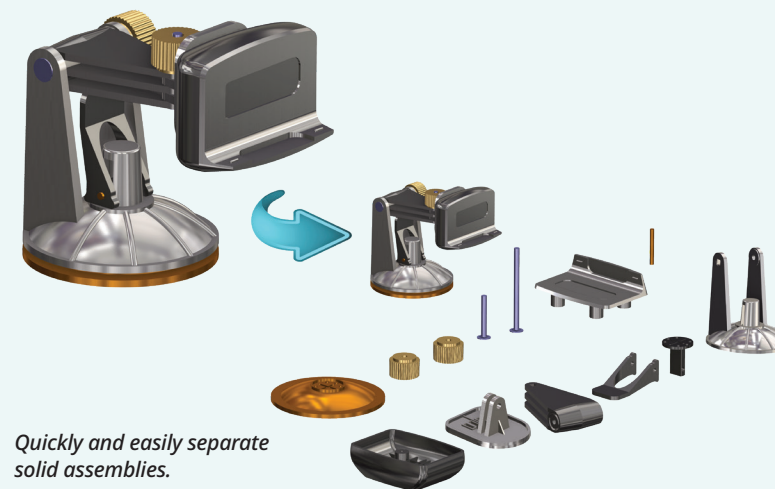

Quickly and easily separate solid assemblies.

Work with your existing CAD files.

Mastercam helps to preserve design intent with Model Based Definition (MBD) support and acceptance of varied file formats. These include IGES, Parasolid®, SAT (ACIS solids), AutoCAD® (DXF, DWG, and Inventor™ files), SOLIDWORKS® (including history tree), Solid Edge®, SpaceClaim, STEP, STL, and more. Add-On translators are available for Siemens NX, CATIA™, Pro/E (PTC Creo), and more.

Whether you are prepping customer files...

Getting a part file from an outside source can pose unique challenges. You might need to repair a surface, work with a mesh, cap or hide a feature, create an electrode, or just make sure your fixtures are represented on the part. Mastercam includes a powerful set of model prep tools to make sure the process goes smoothly. From robust surface creation and editing to “push-pull” solid model editing, Mastercam gives you the tools to bring a part from the designer's desk to your machining process, fast.

...or designing your parts from scratch.

Having powerful CAD at your fingertips makes your CAM system that much more effective. Mastercam includes a robust set of modeling tools, from complete wireframe to surface and solid modeling. A true hybrid modeling system, Mastercam lets you create, combine, and machine whichever CAD geometry suits your needs.

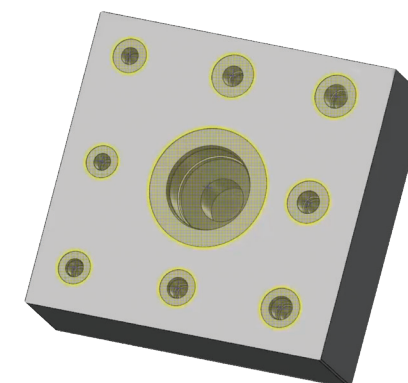
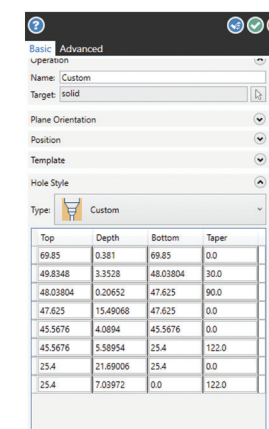

Automatically identify complex hole geometry including intersecting and non-conventional holes.