

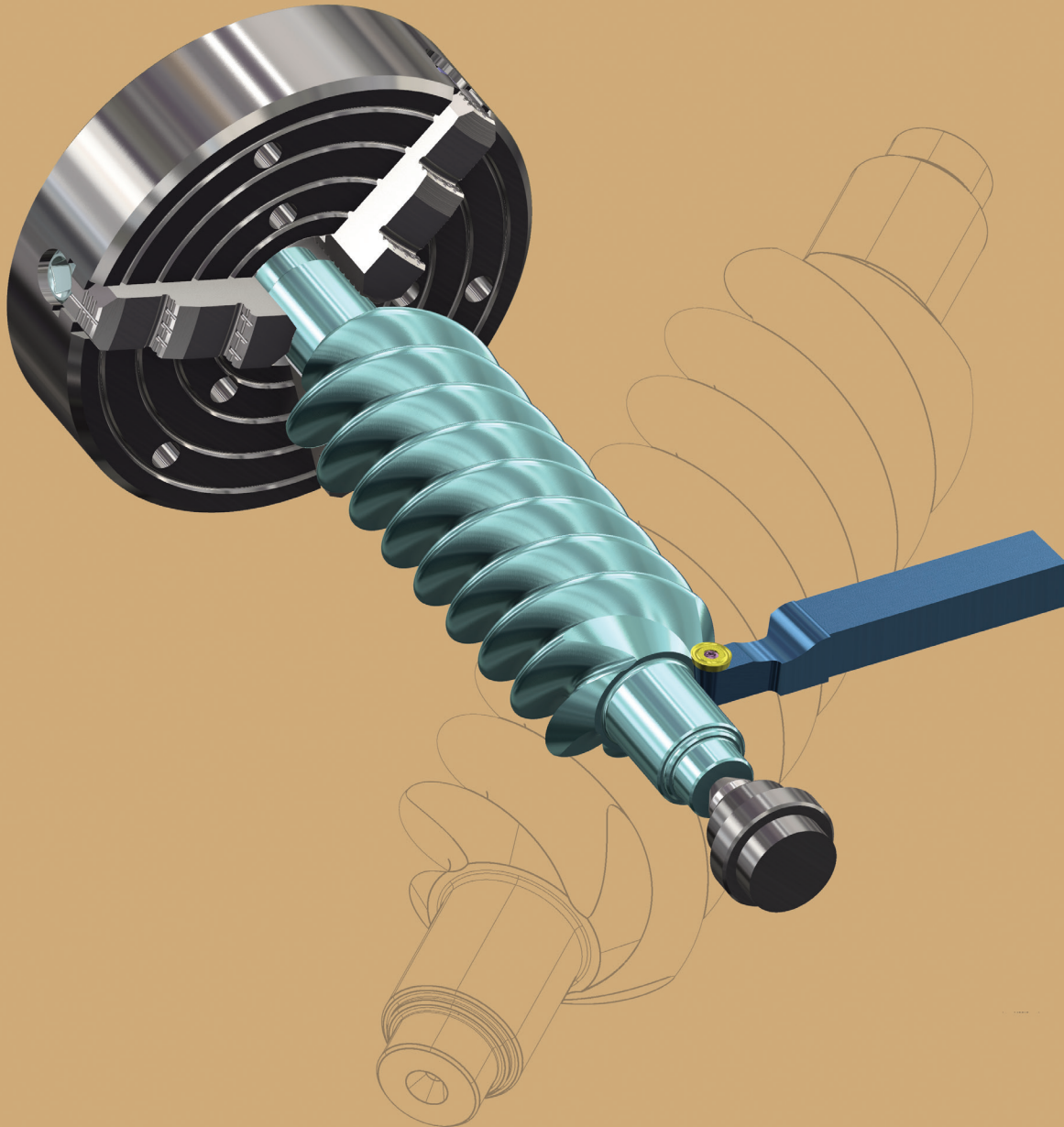

LATHE



Mastercam Lathe lets you move the same part file between milling and turning operations with ease and confidence.



Mastercam Lathe includes the option to run a corresponding **Mastercam for SOLIDWORKS®** environment. Standalone licenses of Mastercam for SOLIDWORKS® Lathe are also available for purchase.

POWERFUL, FLEXIBLE TOOLS FOR TURNING

A set of tools that streamlines your entire process.

From importing CAD files to Dynamic roughing and precision finishing, Mastercam Lathe gives you a variety of strategies to turn parts with greater efficiency and productivity.

Efficient programming, designed for modern manufacturing.

Mastercam Lathe delivers a set of easy-to-use, advanced programming tools, with greatly expanded options when paired with Mastercam Mill. Easy rough, finish, thread, groove, bore, and drill routines combine with C/Y-axis machining to cut any job. Dependable toolpath verification ensures your parts are done right the first time.

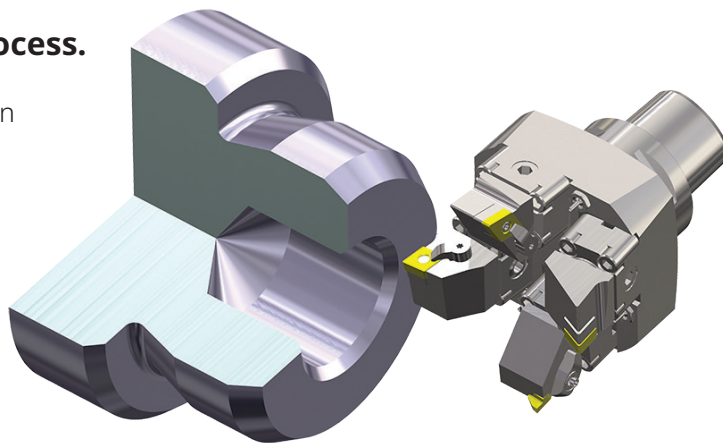

Select lathes offer expanded job setup, part transfer, and programming options.

SAVE TIME AND MONEY

100 Hastelloy parts cut with and without Dynamic Motion toolpaths.

WITHOUT DYNAMIC



X

\$100/hour machine cost
= **\$500**

12.5 inserts per part @ \$25
= **\$312.50**



\$812.50 per part x 100 parts
= **\$81,250**

WITH DYNAMIC



X

\$100/hour machine cost
= **\$66**

1.5 inserts per part @ \$25
= **\$37.50**



\$103.50 per part x 100 parts
= **\$10,350**

Cycle time and cost reduction of 87%

Fast, easy turning.

- Program in a few clicks with **Quick Toolpaths**.
- Complete threading including **custom thread forms**.
- Grooving with multiple depth cuts, peck motion, and full-radius plunge turning.
- Intelligent ID, OD, face roughing, and finishing.
- **Full milling support available** for machines with live tooling or C and Y axes.

Safe machine and cut control.

- Chuck, part, steady rest, and tailstock detection.
- Automatic gouge checking on the tool's front and back.
- Control chip breakage on difficult-to-machine materials.
- Full collet and solid jaw support.
- Expanded job setup, part transfer, and programming options on select lathes.



Protect your CAD/CAM investment with Mastercam Maintenance. Keep your turning strategies and technology up to date with ongoing software updates and exclusive Maintenance benefits.